

RAK-COMPACT

Wall Hung | Water Closet

RAK
CERAMICS

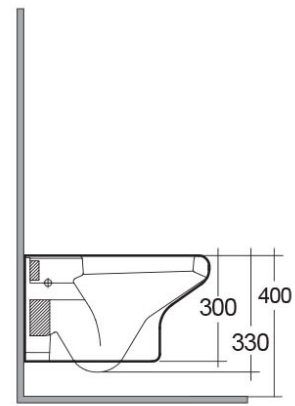
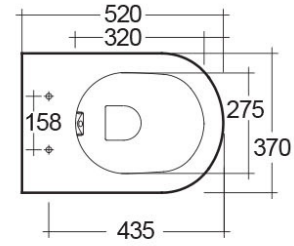

Technical specifications

Dimensions: 520 x 370 mm

Weight: 19 Kg

Color: Alpine White

Trap type: P Trap

Trapway type: Concealed

Seat cover options: Urea

Bowl shape: Round

Dual flush: yes

Suites: [RAK-COMPACT](#)

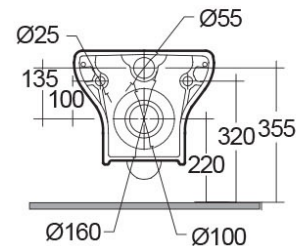

Code	Name
------	------

COMWHPAN-HF	COMPACT WATER CLOSET WALL HUNG 52CM
-------------	-------------------------------------

Dimensions: All dimensions in mm tolerance $\pm 5\%$ for below 200mm and $\pm 3\%$ for above 200mm.

Note: Due to a continuing development programme to improve design and performance, the manufacturer reserves all rights to vary specifications without prior information.

Please note accessories are for photographic use only.